

Drury Plaza Hotel Nashville Downtown

## DRURY PLAZA HOTEL NASHVILLE | DOWNTOWN

300 Korean Veterans Boulevard, Nashville, TN 37201

Located in the SoBro district of Nashville, the Drury Plaza Hotel Nashville Downtown, with its 389 spacious guestrooms and over 14,000 square feet of meeting space, is the heart of Music City. Enjoy a casual meal or drink at the Kitchen + Bar on the 8th floor before a quick walk to the Music City Center or the multitude of honky tonks on Broadway! The Drury Plaza Hotel is the perfect location for your next event or meeting.

### ROOM TYPES

**389** spacious guestrooms & two-room suites

- 182 deluxe king rooms
- 169 deluxe double queen rooms
- 38 deluxe two-room suites

### MEETING SPACE

**7** total meeting rooms plus prefunction space

**14,000+ sq ft** of flexible meeting room space

**Hybrid Meeting Options** available

### AMENITIES

Free hot breakfast

Free hot food & cold beverages at 5:30 Kickback®

Free Wi-Fi throughout the hotel

The Kitchen + Bar @ SOBRO - located on the eighth floor

24-hour business & fitness centers

Indoor/outdoor pool & whirlpool

Guest market available

Guest laundry & same day dry cleaning (Mon - Fri) available

Microwave & refrigerator in every room

Drury Rewards loyalty program

### PARKING

On-site parking available for a \$35.00 nightly fee

**FOR MORE INFORMATION ON PLANNING YOUR NEXT EVENT,  
PLEASE CONTACT OUR SALES TEAM:**

**Mackenzie Nelson**

E Mackenzie.Nelson@DruryHotels.com

P 615-986-6484

**Tyler Eckenrod**

E Tyler.Eckenrod@DruryHotels.com

P 615-986-3530



Drury Plaza Hotel Nashville Downtown

## Capacities & Dimensions

Room	Dimensions	Sq Ft	Banquet Capacity*	Conference Capacity*	Theater Capacity*	Classroom Capacity*	U-Shape Capacity*	Reception Capacity*
Belmont Ballroom	62' x 38'	2,300	150	55	240	100	66	230
Old Hickory	35' x 19'	665	48	16	74	24	19	67
Charlotte	30' x 27'	775	48	19	86	24	22	78
Belle Meade A	30' x 24'	725	48	17	80	30	21	73
Belle Meade B	30' x 24'	725	48	17	80	30	21	73
Belle Meade (Combined)	30' x 48'	1,450	96	35	161	60	41	145
North Pre-Function	32' x 20'	640	--	--	--	--	--	64
South Pre-Function	63' x 20'	1,200	--	--	--	--	--	120
Tyne	45' x 28'	1,250	72	30	139	52	36	125
Woodmont	36' x 21'	750	48	18	83	24	21	75
Granny White Board Room	21' x 25'	525	--	13	--	--	--	--
Guest Dining	--	4,822	222	--	--	--	--	--
Outdoor Terrace	--	1,567	40	--	--	--	--	--

\* other capacities/arrangements are available, call for details.

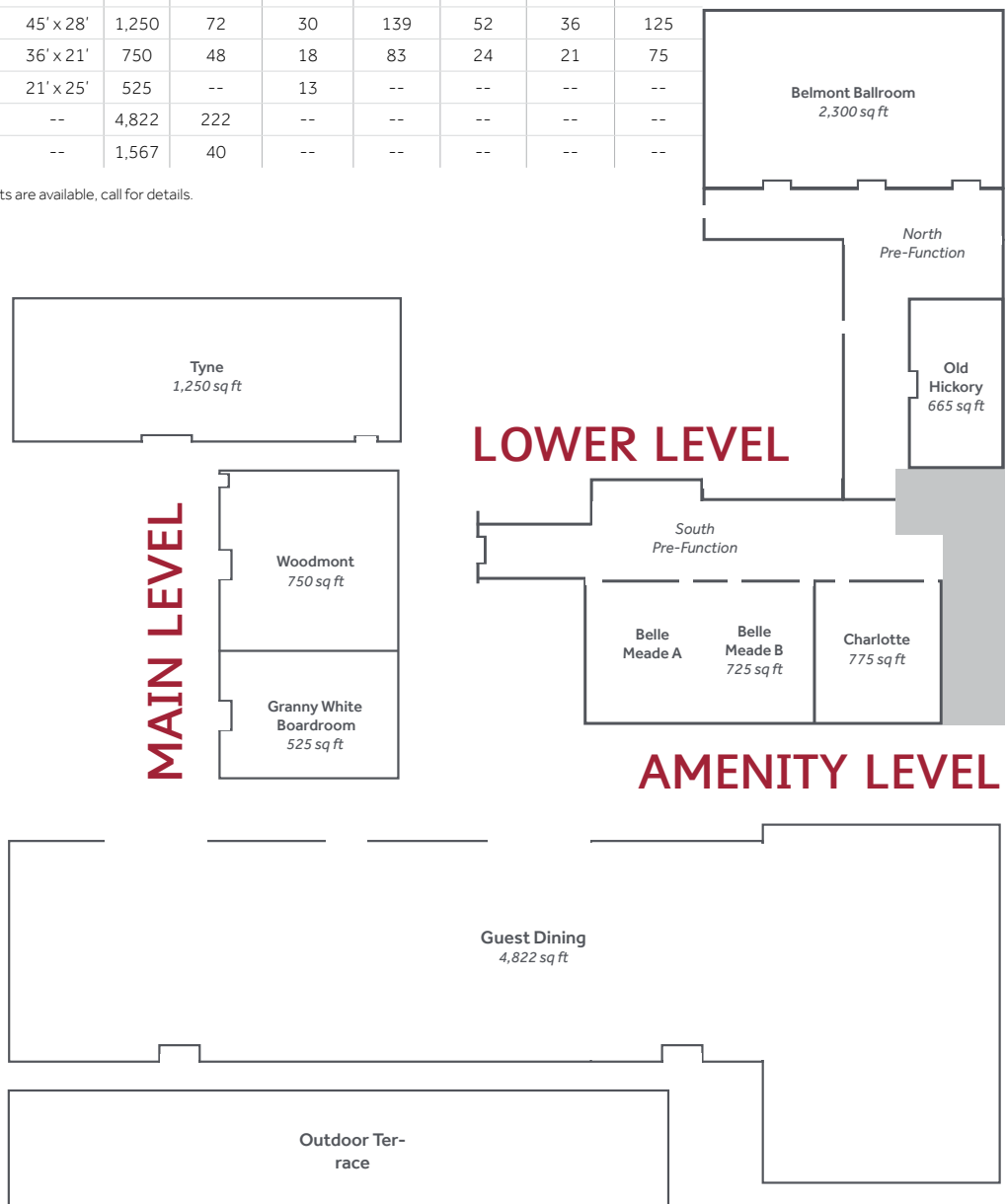

## Break Packages

All options listed below are served individually portioned or served by a staff member.

### Beverage Breaks

All day service - will refresh as needed; 10 person minimum.

- |   |   |
|---|---|
| <ul style="list-style-type: none"> <li>□ <b>Deluxe</b><br/>"Standard" and "Basic" packages (no bulk iced tea), plus...           <ul style="list-style-type: none"> <li>- Premium Bottled Water/Sparkling Water</li> <li>- Assorted/Herbal Teas</li> </ul> </li> <li>□ <b>Standard</b><br/>"Basic" package, plus...           <ul style="list-style-type: none"> <li>- Assorted Soda Cans</li> <li>- Bottled Water</li> </ul> </li> <li>□ <b>Basic</b> <ul style="list-style-type: none"> <li>- Regular/Decaf Coffee &amp; Hot Tea</li> <li>- Iced Tea (bulk) and Infused Water (bulk)</li> </ul> </li> </ul> | <p><b>\$16 / person</b></p> <p><b>\$14 / person</b></p> <p><b>\$11 / person</b></p> |
|---|---|

### recharge food breaks

Pricing valid with purchase of Beverage Break; 45 minute service; 10 person minimum; select items may have a per person upcharge as indicated (\*).

- |  |   |
|--|---|
| <ul style="list-style-type: none"> <li>□ <b>Sweet &amp; Savory</b><br/>Mix &amp; match up to four (4) selections from our "Sweet" or "Savory" list.<br/>Additional selections \$2 / person.</li> <li>□ <b>Sweet Only</b><br/>Mix &amp; match two (2) selections from our "Sweet" list.<br/>Additional selections \$2 / person.</li> <li>□ <b>Savory Only</b><br/>Mix &amp; match two (2) selections from our "Savory" list.<br/>Additional selections \$2 / person.</li> </ul> | <p><b>\$16 / person</b></p> <p><b>\$11 / person</b></p> <p><b>\$11 / person</b></p> |
|--|---|

### A La Carte Beverages

Add. Cost

- |   |      |
|---|------|
| □ Coffee - 1 gal. (regular or decaf)        | \$50 |
| □ Energy Drinks (i.e. Red Bull) (ea)        | \$6  |
| □ Premium or Sparkling Bottled Water (ea)   | \$5  |
| □ Black & Herbal Tea with Hot Water (ea)    | \$4  |
| □ Soda/Juice/Water (by the can/bottle) (ea) | \$3  |

### Sweet Selections

Add. Cost

- |                              |     |
|------------------------------|-----|
| □ Greek Yogurt Cups          | \$2 |
| □ Ice Cream                  | \$2 |
| □ Premium "Power" Bars       | \$2 |
| □ Candy Bars/Gummi Bears     | -   |
| □ Cookies/Brownies           | -   |
| □ Fresh Fruit                | -   |
| □ Granola Bars/Cereal Bars   | -   |
| □ Mini Pastry/Danish/Muffins | -   |
| □ Rice Krispy Treats         | -   |
| □ Yogurt Cups                | -   |

\* other options may be available upon request

### Savory Selections

Add. Cost

- |                        |     |
|------------------------|-----|
| □ Guacamole with Chips | \$2 |
| □ Jerky                | \$2 |
| □ Hummus with Pretzels | \$2 |
| □ Hard Boiled Eggs     | -   |
| □ Kettle Potato Chips  | -   |
| □ Popcorn              | -   |
| □ Pretzels             | -   |
| □ Salsa with Chips     | -   |
| □ Trail Mix            | -   |

\* other options may be available upon request

Prices are subject to change and are exclusive of service charge and local sales tax.

Drury Plaza Hotel Nashville Downtown

## Catering Options

Below is a list of our preferred catering vendors.

### **Dream Events & Catering**

[DreamEventsandCatering.com](http://DreamEventsandCatering.com)

**P** 615-259-0848

Dream Events & Catering is a full-service event and catering company. Whether the event is large or small, social or corporate, Dream Events & Catering's wide range of event and catering services can be tailored to fit unique needs. As all-inclusive and full-service as needed, from event planning & florals to entertainment, rentals, and delicious food. With experienced event specialists and a full culinary team, the Dream Team is here to create an event that is dreamy & delicious!

## Audio-Visual Equipment\*

Complimentary high-speed Wi-Fi is available in all meeting rooms. Our AV partner can provide any required equipment not listed below. Let our team of experts help you determine your unique technology needs to meet the goals of your event.

ITEM	PRICE
□ High-Speed Wi-Fi	FREE
□ Hybrid Meeting Package	call for details
□ Standard AV Support Package	
□ LCD Projector & Screen	\$350.00 / day
□ AV Cart	
□ Executive AV Support Package	
□ LCD Projector & Screen	
□ AV Cart	\$500.00 / day
□ Standing Podium with Choice of Microphone	
□ Wireless Presenter with Laser Pointer	
□ LCD Projector	\$250.00
□ Wireless Lapel or Handheld Microphone	\$100.00
□ Polycom Speaker Phone	\$150.00
□ Flipchart with Easel & Markers	\$60.00
□ 47" TV, VCR, DVD Player	\$200.00
□ Powerstrips/Extension Cords	\$25.00 / per
□ Confidence Monitor	\$100.00 / per

\* For the convenience of meeting planners, groups may bring their own audio visual equipment if desired. If the group requires equipment not carried by the hotel, equipment will be ordered from an approved local AV supplier and the customer will be billed the suppliers price through the hotel on the Banquet Event Order. AV equipment and pricing are subject to change.

All AV equipment includes an extension cord and powerstrip. Pricing and available equipment are subject to change. Listed AV is priced per day and is exclusive of tax.