



## DRURY PLAZA HOTEL ORLANDO | DISNEY SPRINGS® AREA

2000 Hotel Plaza Boulevard, Lake Buena Vista, FL 32830

Conveniently located within the *Disney Springs*® Resort Area, the Drury Plaza Hotel is an *Official Walt Disney World*® Hotel offering flexible spaces to host your next meeting. Our best-in-class amenity and meeting spaces can be customized amidst the magic and wonder of a Disney experience. Simply provide our award-winning team with the details and let us give you the personal attention and planning you deserve.

### ROOM TYPES

**602** spacious guestrooms & two-room suites

- 177 deluxe king rooms
- 347 deluxe double queen rooms
- 78 deluxe two-room suites

### MEETING SPACE

**10** total meeting rooms plus prefunction space

**17,000+ sq ft** of flexible meeting & prefunction space

### AMENITIES

- Free hot breakfast
- Free dinnertime snacks & beverages at 5:30 Kickback®
- Free Wi-Fi throughout the hotel
- The Kitchen + Bar - *Lobby Bar*
- Lakeside Bar + Grill - *Poolside Restaurant*
- Guest market available - Including *Pizza Hut Express*® and *Starbucks*® Coffee
- 24-hour business & fitness centers
- Resort-style pool & splash pad
- Microwave and refrigerator in every room
- Drury Rewards loyalty program
- Complimentary shuttle service delivering you closer to the magic

### PARKING

On-site parking available for a nightly fee



Actual meeting rooms may differ from photo.

## Capacities & Dimensions

Meeting Room	Dimensions	Ceiling Height	Sq Ft	Maximum Capacity	Banquet	Conference	Theater	Classroom	U-Shape
Scarlet Ballroom	96' x 45'	12.3'	4,272	474	355		474	178	122
Scarlet A	24' x 45'	12.3'	1,080	120	90	26	120	45	31
Scarlet B	24' x 45'	12.3'	1,080	120	90	26	120	45	31
Scarlet C	24' x 45'	12.3'	1,080	120	90	26	120	45	31
Scarlet D	23' x 45'	12.3'	1,080	120	90	26	120	45	31
Coral Ballroom	96' x 49'	12.3'	4,656	517	387		517	194	133
Coral A	24' x 49'	12.3'	1,176	131	98	28	131	49	34
Coral B	24' x 49'	12.3'	1,176	131	98	28	131	49	34
Coral C	24' x 49'	12.3'	1,176	131	98	28	131	49	34
Coral D	23' x 49'	12.3'	1,176	131	98	28	131	49	34
The City Beautiful Terrace	42' x 35'	12'	1,290	129	107				
Pre-Function Space	88' x 32'	15'	2,816	282					
The Commons - 2nd Floor	130' x 40'	12'	5,200	505	505				

For more information, please contact:  
[druryplazaorlandosales@druryhotels.com](mailto:druryplazaorlandosales@druryhotels.com)

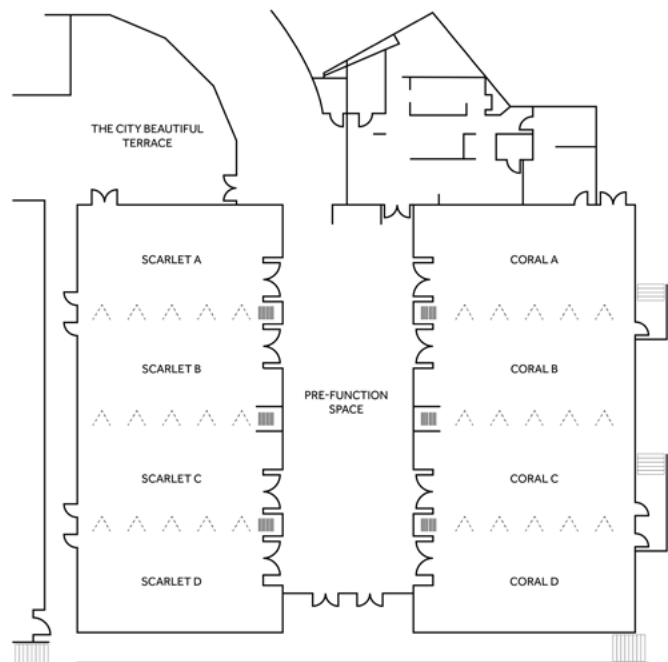

## Beverage Breaks

All day service - will refresh as needed; 10 person minimum.

- **Deluxe** **\$18 / person**  
*"Standard" and "Basic" packages, plus...*

  - Coca-Cola® products/premium bottled water/sparkling water
  - Assorted Starbucks® coffee/specialty drinks/teas
- **Standard** **\$14 / person**  
*"Basic" package, plus...*

  - Coca-Cola® products
  - Nestlé Bottled Water
- **Basic** **\$11 / person**

  - Regular/Decaf Coffee & Hot Tea
  - Iced Tea and Infused Water

## Recharge Food Breaks

Pricing valid with purchase of Beverage Break; 45 minute service; 10 person minimum; select items may have a per person upcharge as indicated (\*).

- **Sweet & Savory** **\$16 / person**  
 Mix & match up to four (4) selections from our "Sweet" or "Savory" list.  
*Additional selections \$2 / person.*
- **Sweet Only** **\$12 / person**  
 Mix & match two (2) selections from our "Sweet" list.  
*Additional selections \$2 / person.*
- **Savory Only** **\$12 / person**  
 Mix & match two (2) selections from our "Savory" list.  
*Additional selections \$2 / person.*

## Other Food Options

- **Drury's Hot Breakfast** **\$10.99 / person**  
 A variety of hot food options, cereal, pastries, bagels and more.  
 Served daily - 6:00 - 9:30 am Monday - Friday & 7:00 - 10:00 am  
 Saturday & Sunday - in the main dining area only.
- **Drury's 5:30 Kickback®** **\$15.99 / person**  
 Rotating menu of hot food options, hearty soups, healthy salads and more.  
 Served nightly - 5:30 - 7:30 pm - in the main dining area only.  
*Alcoholic beverages not included for non-hotel guests.*

Prices are subject to change and are exclusive of service charge and local sales tax.

## A La Carte Beverages

Add. Cost

- Coffee - 1.5 gal. (regular or decaf) \$60
- Starbucks® Coffee 1.5 gal. (regular or decaf) \$75
- Premium or Sparkling Bottled Water (ea) \$5
- Black & Herbal Tea with Hot Water (ea) \$4
- Soda/Juice/Water (by the can/bottle) (ea) \$4

## Sweet Selections

Add. Cost

- Greek Yogurt Cups \$4
- Ice Cream \$4
- Premium "Power" Bars \$4
- Candy Bars/Gummi Bears \$4
- Cookies/Brownies \$3
- Fresh Fruit \$3
- Granola Bars/Cereal Bars \$3
- Mini Pastry/Danish/Muffins \$4
- Rice Krispy Treats \$3
- Yogurt Cups \$3

\*other options may be available upon request

## Savory Selections

Add. Cost

- Guacamole with Chips \$5
- Jerky \$5
- Hummus with Pita Chips \$5
- Hard Boiled Eggs \$3
- Kettle Potato Chips \$3
- Popcorn \$3
- Pretzels \$3
- Salsa with Chips \$3
- Trail Mix \$3

\*other options may be available upon request

All options are served individually portioned.

## Audio-Visual Equipment\*

Complimentary high-speed Wi-Fi is available in all meeting rooms. Our AV partner can provide any required equipment not listed below. Let our team of experts help you determine your unique technology needs to meet the goals of your event.

ITEM	PRICE
□ High-Speed Wi-Fi	FREE
□ Charging Station	FREE
□ Hybrid Meeting Package	call for details
□ Standard AV Support Package	
□ LCD Projector & Screen	\$250.00 / day
□ AV Cart	
□ Executive AV Support Package	
□ LCD Projector & Screen	
□ AV Cart	\$400.00 / day
□ Standing Podium with Choice of Microphone	
□ Wireless Presenter with Laser Pointer	
□ LCD Projector	\$150.00
□ Wireless Lapel or Handheld Microphone	\$100.00
□ Polycom Speaker Phone	\$50.00
□ Flipchart with Easel & Markers	\$40.00
□ 47" TV, VCR, DVD Player	\$160.00
□ Powerstrips/Extension Cords	\$10.00 / per

\* For the convenience of meeting planners, groups may bring their own audio visual equipment if desired. If the group requires equipment not carried by the hotel, equipment will be ordered from an approved local AV supplier and the customer will be billed the suppliers price through the hotel on the Banquet Event Order. AV equipment and pricing are subject to change.

All AV equipment includes an extension cord and powerstrip. Pricing and available equipment are subject to change. Listed AV is priced per day and is exclusive of tax.