

Drury Plaza Hotel Broadview Wichita

DRURY PLAZA HOTEL BROADVIEW | WICHITA

400 West Douglas Avenue, Wichita, KS 67202

Located on the Arkansas River banks in Wichita, the historic Broadview Hotel originally opened its doors in 1922. In 2011, the Drury family purchased and began a complete renovation of the hotel, preserving the Broadview's large chandeliers, ornate ornamental features and an original mosaic mural installed by Native American artist Blackbear Bosin. The Drury Plaza Hotel Broadview Wichita features 200 spacious guestrooms and over 11,000 square feet of unforgettable meeting space.

ROOM TYPES

200 spacious guestrooms & two-room suites

- 93 deluxe king rooms
- 83 deluxe double queen rooms
- 24 deluxe two-room suites

MEETING SPACE

7 total meeting rooms plus prefunction space

13,000+ sq ft of flexible meeting room space

Hybrid Meeting Options available

AMENITIES

Free hot breakfast

Free hot food & cold beverages at 5:30 Kickback®

Free Wi-Fi throughout the hotel

24-hour business & fitness centers

Indoor pool & whirlpool

Guest market available

Guest laundry & same day dry cleaning (Mon - Fri) available

Microwave & refrigerator in every room

Drury Rewards loyalty program

PARKING

On-site parking available for a nightly fee

**FOR MORE INFORMATION ON PLANNING YOUR NEXT EVENT,
PLEASE CONTACT OUR SALES TEAM AT:**

E Leah.Stotts@DruryHotels.com

P 316-358-6807



Drury Plaza Hotel Broadview Wichita

Capacities & Dimensions

A sales representative can help identify the best set-up based on local capacity guidelines and social distancing.

Meeting Room	Dimensions	Sq Ft	Maximum Capacity
Bosin Ballroom	156' x 59'	9,204	860
Bosin 1	52' x 59'	3,068	320
Bosin 2	52' x 59'	3,068	320
Bosin 3	52' x 59'	3,068	320
Station Room	52' x 38'	1,976	200
Station 1	27' x 38'	1,026	120
Station 2	25' x 38'	950	90
Siedhoff Salon	33' x 21'	693	70
Viola Boardroom	22' x 19'	418	10
Waco Lobby	117' x 49'	5,733	250
River View & South Lobby	N/A	4,763	120
Mezzanine	N/A	4,431	140

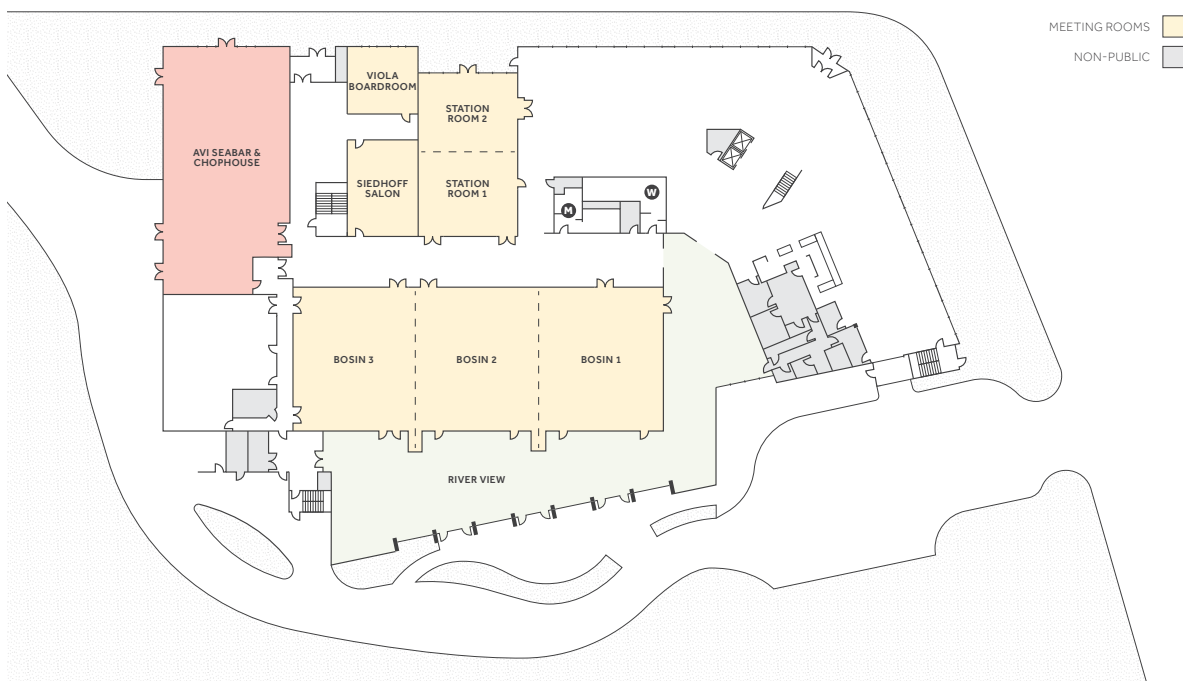

Drury Plaza Hotel Broadview Wichita

Catering Options

All caterers are required to adhere to CDC guidelines. Below is a list of our preferred catering vendors.

Corporate Caterers of Wichita

CorporateCaterersofWichita.com

Corporate Caterers of Wichita will assist you with all break packages and meal options for your event.

☎ 316-264-9167

Drury Plaza Hotel Broadview Wichita

Audio-Visual Equipment*

Complimentary high-speed Wi-Fi is available in all meeting rooms. Audio-visual equipment is provided by Audio Visual Services. Arrangements can be confirmed by calling 316-807-0915.

ITEM	PRICE
<input type="checkbox"/> High-Speed Wi-Fi	FREE
<input type="checkbox"/> Charging Station FREE	FREE
<input type="checkbox"/> Hybrid Meeting Package	call for details
<input type="checkbox"/> Standard HD Projector	\$150
<input type="checkbox"/> Large Venue HD Projector/Long Throw Lens & Truss	\$400
<input type="checkbox"/> Roland UVC-01 Video Capture	\$50
<input type="checkbox"/> 50" HD TV W/Cart & Skirt	\$200
<input type="checkbox"/> Kramer/Aurora HDMI Extender System	\$150
<input type="checkbox"/> VGA Distribution Amp	\$25
<input type="checkbox"/> Midas M32 Digital Console	\$200
<input type="checkbox"/> 4/2 Channel Mic Mixer	\$35
<input type="checkbox"/> QSC K12 Powered Speaker & Stand	\$50/ea
<input type="checkbox"/> Shure Mx412/D Podium Mic	\$15
<input type="checkbox"/> Tascam Pro DVD Player	\$40
<input type="checkbox"/> Tascam Pro CD Player	\$40
<input type="checkbox"/> Panasonic AGAC 130 A HD Camera/Fluid Head Tripod	\$250
<input type="checkbox"/> Roland V40 Video Switcher/Scaler	\$250
<input type="checkbox"/> 24" Confidence Monitor	\$50
<input type="checkbox"/> Elipsolid LED Stage Lighting System W/Controller/Stands	\$350
<input type="checkbox"/> LED Color Up Lighting	\$45 per can
<input type="checkbox"/> Wireless Clicker/Pointer	\$20
<input type="checkbox"/> 7' X 10' Fast Fold Screen W/Full Drape	\$90
<input type="checkbox"/> 9' X 12' Fast Fold Screen W/Full Drape	\$95
<input type="checkbox"/> Black Velvet Pipe and Drape (24' Total)	\$65 per 12ft
<input type="checkbox"/> 25', 50', 100' VGA Cable	\$10
<input type="checkbox"/> QF 1000 Follow Spot/Stand	\$60
<input type="checkbox"/> Polycom Soundstation Conference Phone	\$60
<input type="checkbox"/> Show Technician	\$50/hr
<input type="checkbox"/> Equipment Delivery/Pickup	\$60

It is agreed that this is for rental only for the period specified and I am responsible for the safe return of the above equipment or for payment of the full list price. I agree that I will be billed for all damages to the merchandise other than damages caused by normal operations.