

Drury Plaza Hotel Nashville Downtown

DRURY PLAZA HOTEL NASHVILLE | DOWNTOWN

300 Korean Veterans Boulevard, Nashville, TN 37201

Our team is ready to deliver prompt, personalized service to ensure your event will make a big impact. Customize your meeting with flexible catering and audio-visual options, and enjoy affordable pricing without hidden fees.

MEETING SPACE

7 meeting rooms

- 14,000+ sq ft of meeting room space
- Accommodates up to 240 in largest capacity space

ROOM TYPES

389 spacious guestrooms & two-room suites

- 182 deluxe king rooms
- 169 deluxe double queen rooms
- 38 deluxe two-room suites

AMENITIES



Free
Hot Breakfast



Free
5:30 Kickback®



Free
Wi-Fi

The Kitchen + Bar @ SOBRO - *located on the eighth floor*
24-hour business & fitness centers
Indoor/outdoor pool & whirlpool
Guest market available
Guest laundry & same day dry cleaning (Mon - Fri) available
Microwave & refrigerator in every room
Drury Rewards® loyalty program

PARKING

On-site parking available for a \$35.00 nightly fee

**FOR MORE INFORMATION ON PLANNING YOUR NEXT EVENT,
PLEASE CONTACT OUR SALES TEAM:**

Mackenzie Nelson

E Mackenzie.Nelson@DruryHotels.com

P 615-986-6484

Tyler Eckenrod

E Tyler.Eckenrod@DruryHotels.com

P 615-986-3530



Drury Plaza Hotel Nashville Downtown

Capacities & Dimensions

We offer a variety of customizable set-up options to make your next event a success.

Room	Dimensions	Sq Ft	Banquet Capacity*	Conference Capacity*	Theater Capacity*	Classroom Capacity*	U-Shape Capacity*	Reception Capacity*
Belmont Ballroom	62' x 38'	2,300	160	48	280	165	60	230
Old Hickory	35' x 19'	665	40	24	96	36	30	67
Charlotte	30' x 27'	775	40	24	90	48	21	78
Belle Meade A	30' x 24'	725	48	18	96	48	21	73
Belle Meade B	30' x 24'	725	48	18	96	48	21	73
Belle Meade (Combined)	30' x 48'	1,450	88	36	160	96	45	145
North Pre-Function	32' x 20'	640	--	--	--	--	--	64
South Pre-Function	63' x 20'	1,200	--	--	--	--	--	120
Tyne	45' x 28'	1,250	80	30	139	54	39	125
Woodmont	36' x 21'	750	40	24	96	36	30	75
Granny White Board Room	21' x 25'	525	--	12	--	--	--	--
Guest Dining	--	4,822	222	--	--	--	--	--
Outdoor Terrace	--	1,567	40	--	--	--	--	--

* other capacities/arrangements are available, call for details.

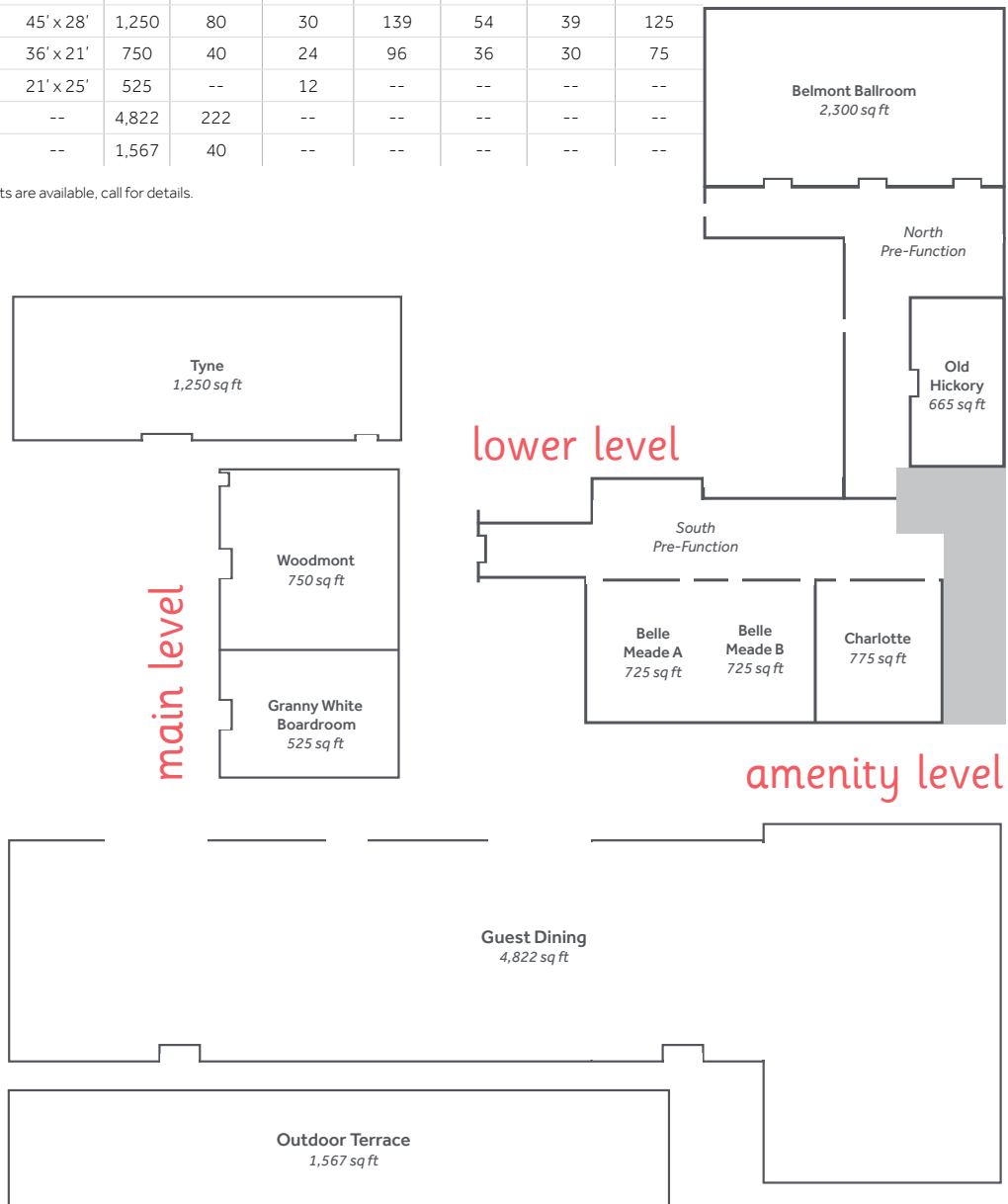

Drury Plaza Hotel Nashville Downtown

Break Packages

We offer all-day beverage service, as well as AM or PM breaks, so your meeting never runs out of steam.

Beverage Breaks

All day service - will refresh as needed; 10 person minimum.

- Deluxe** **\$16 / person**
"Standard" and "Basic" packages (no bulk iced tea), plus...
 - Premium Bottled Water/Sparkling Water
 - Assorted/Herbal Teas
- Standard** **\$14 / person**
"Basic" package, plus..
 - Assorted Soda Cans
 - Bottled Water
- Basic** **\$11 / person**
 - Regular/Decaf Coffee & Hot Tea
 - Iced Tea (bulk) and Infused Water (bulk)

recharge food breaks

Pricing valid with purchase of Beverage Break; 45 minute service; 10 person minimum; select items may have a per person upcharge as indicated (*).

- Sweet & Savory** **\$16 / person**
 Mix & match up to four (4) selections from our "Sweet" or "Savory" list.
Additional selections \$2 / person.
- Sweet Only** **\$11 / person**
 Mix & match two (2) selections from our "Sweet" list.
Additional selections \$2 / person.
- Savory Only** **\$11 / person**
 Mix & match two (2) selections from our "Savory" list.
Additional selections \$2 / person.

other food options

- Drury's Hot Breakfast** **\$10.99 / person**
 A variety of hot food options, cereal, pastries, bagels and more.
 Served daily - 6:00 - 9:30 am Monday - Friday & 7:00 - 10:00 am Saturday & Sunday - in the main dining area only.
- Drury's 5:30 Kickback®** **\$12.99 / person**
 Rotating menu of hot food options, hearty soups, healthy salads and more.
 Served nightly - 5:30 - 7:00 pm - in the main dining area only.
Alcoholic beverages not included for non-hotel guests.

Prices are subject to change and are exclusive of service charge and local sales tax.

A La Carte Beverages

Add. Cost

- Coffee - 1.5 gal. (regular or decaf) \$50
- Energy Drinks (i.e. Red Bull) (ea) \$6
- Premium or Sparkling Bottled Water (ea) \$5
- Black & Herbal Tea with Hot Water (ea) \$4
- Soda/Juice/Water (by the can/bottle) (ea) \$3

Sweet Selections

Add. Cost

- Greek Yogurt Cups \$2
- Ice Cream \$2
- Premium "Power" Bars \$2
- Candy Bars/Gummi Bears -
- Cookies/Brownies -
- Fresh Fruit -
- Granola Bars/Cereal Bars -
- Mini Pastry/Danish/Muffins -
- Rice Krispy Treats -
- Yogurt Cups -

*other options may be available upon request

Savory Selections

Add. Cost

- Guacamole with Chips \$3
- Jerky \$3
- Hummus with Pita Chips \$2
- Hard Boiled Eggs -
- Kettle Potato Chips -
- Popcorn -
- Pretzels -
- Salsa with Chips -
- Trail Mix -

*other options may be available upon request

Drury Plaza Hotel Nashville Downtown

Catering Options

Below is our preferred catering vendor.

Dream Events & Catering

DreamEventsandCatering.com

☎ 615-259-0848

Dream Events & Catering is a full-service event and catering company. Whether the event is large or small, social or corporate, Dream Events & Catering's wide range of event and catering services can be tailored to fit unique needs. As all-inclusive and full-service as needed, from event planning & florals to entertainment, rentals, and delicious food. With experienced event specialists and a full culinary team, the Dream Team is here to create an event that is dreamy & delicious!

Drury Plaza Hotel Nashville Downtown

Audio-Visual Equipment*

Drury Hotels proudly offers a selection of onsite audio-visual equipment available to rent. If your audio-visual request cannot be accommodated using our onsite equipment, our National Group Sales Coordinators can assist in obtaining the additional equipment for your meeting.

ITEM	PRICE
□ High-Speed Wi-Fi	FREE
□ Hybrid Meeting Package	call for details
□ Standard AV Support Package	
□ LCD Projector & Screen	\$350 / day
□ AV Cart	
□ Executive AV Support Package	
□ LCD Projector & Screen	
□ AV Cart	\$500 / day
□ Standing Podium with Choice of Microphone	
□ Wireless Presenter with Laser Pointer	
□ LCD Projector	\$250
□ Wireless Lapel or Handheld Microphone	\$100
□ Polycom Speaker Phone	\$150
□ Flipchart with Easel & Markers	\$60
□ 47" TV, DVD Player	\$200
□ Powerstrips/Extension Cords	\$25 / per
□ Confidence Monitor	\$100 / per

* For the convenience of meeting planners, groups may bring their own audio visual equipment if desired. If the group requires equipment not carried by the hotel, equipment will be ordered from an approved local AV supplier and the customer will be billed the suppliers price through the hotel on the Banquet Event Order. AV equipment and pricing are subject to change.

All AV equipment includes an extension cord and powerstrip. Pricing and available equipment are subject to change. Listed AV is priced per day and is exclusive of tax.