

Drury Plaza Hotel New Orleans

## DRURY PLAZA HOTEL NEW ORLEANS

820 Poydras Street, New Orleans, LA 70112

Our team is ready to deliver prompt, personalized service to ensure your event will make a big impact. Customize your meeting with flexible catering and audio-visual options, and enjoy affordable pricing without hidden fees.

### MEETING SPACE

7 total meeting rooms plus prefunction space

- 15,000+ sq ft of flexible meeting room space
- Accommodates up to 500 in largest capacity space

### ROOM TYPES

214 spacious guestrooms & two-room suites

- 72 deluxe king bed rooms
- 63 deluxe double queen rooms
- 79 deluxe two-room suites

### AMENITIES



Free  
Hot Breakfast



Free  
5:30 Kickback®



Free  
Wi-Fi

The Kitchen + Bar @ Cumberland Switch - *Open late, every night*

24-hour business & fitness centers

Heated outdoor courtyard pool & whirlpool

Guest market available

Guest laundry & same day dry cleaning (Mon - Fri) available

Microwave & refrigerator in every room

Drury Rewards® loyalty program

### PARKING

On-site covered parking available for a nightly fee

**FOR MORE INFORMATION ON PLANNING YOUR NEXT EVENT,  
PLEASE CONTACT CHRISTY BORREL AT:**

**E** Christy.Borrel@DruryHotels.com

**P** 504-380-8326



Drury Plaza Hotel New Orleans

## Capacities & Dimensions

We offer a variety of customizable set-up options to make your next event a success.

Meeting Room	Dimensions	Sq Ft	Banquet	Conference	Theater	Classroom	U-Shape
Grand Ballroom	94' x 64'	5,538	350	80	500	300	60
Ballroom A	29' x 64'	1,802	125	40	150	100	30
Ballroom B	34' x 64'	2,023	150	40	200	110	30
Ballroom C	30' x 64'	1,713	125	40	150	100	40
Ballroom AB	63' x 64'	3,825	180	60	300	200	40
Ballroom BC	64' x 64'	3,736	180	60	300	200	40
Canal	21' x 30'	570	40	18	50	30	14
Poydras	20' x 30'	591	50	20	16	35	15
Carondelet	20' x 30'	552	40	18	50	30	14

- MEETING ROOMS
- ELEVATORS/STAIRWELLS
- RESTROOMS
- NON-PUBLIC

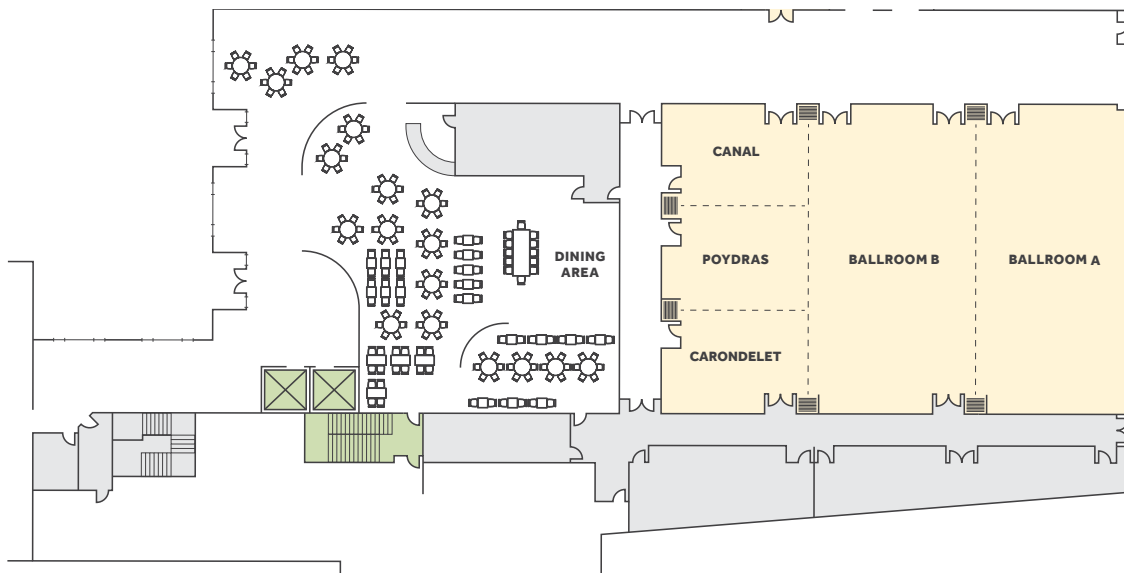

Drury Plaza Hotel New Orleans

## Break Packages

We offer all-day beverage service, as well as AM or PM breaks, so your meeting never runs out of steam.

**No food & beverage minimum is required.**

## Beverage Breaks

All day service - will refresh as needed; 10 person minimum.

- **Deluxe** **\$16 / person**  
*"Standard" and "Basic" packages (no bulk iced tea), plus...*
  - Premium Bottled Water/Sparkling Water
  - Assorted/Herbal Teas
- **Standard** **\$13 / person**  
*"Basic" package, plus...*
  - Assorted Soda Cans
  - Bottled Water
- **Basic** **\$10 / person**
  - Regular/Decaf Coffee & Hot Tea
  - Iced Tea (bulk) and Infused Water (bulk)

## Recharge Food Breaks

Pricing valid with purchase of Beverage Break; 45 minute service; 10 person minimum; select items may have a per person upcharge as indicated (\*).

- **Sweet & Savory** **\$17 / person**  
 Mix & match up to four (4) selections from our "Sweet" or "Savory" list.  
*Additional selections \$2 / person.*
- **Sweet Only** **\$11 / person**  
 Mix & match two (2) selections from our "Sweet" list.  
*Additional selections \$2 / person.*
- **Savory Only** **\$11 / person**  
 Mix & match two (2) selections from our "Savory" list.  
*Additional selections \$2 / person.*

## Other Food Options

- **Drury's Hot Breakfast** **\$10.99 / person**  
 A variety of hot food options, cereal, pastries, bagels and more.  
 Served daily - 6:00 - 9:30 am Monday - Friday & 7:00 - 10:00 am Saturday & Sunday - in the main dining area only.
- **Drury's 5:30 Kickback®** **\$12.99 / person**  
 Rotating menu of hot food options, hearty soups, healthy salads and more.  
 Served nightly - 5:30 - 7:00 pm - in the main dining area only.  
*Alcoholic beverages not included for non-hotel guests.*

Prices are subject to change and are exclusive of service charge and local sales tax.

## A La Carte Beverages

Add. Cost

- Coffee - 1.5 gal. (regular or decaf) \$48
- Energy Drinks (i.e. Red Bull) (ea) \$6
- Premium or Sparkling Bottled Water (ea) \$5
- Black & Herbal Tea with Hot Water (ea) \$3
- Soda/Juice/Water (by the can/bottle) (ea) \$3

## Sweet Selections

Add. Cost

- Greek Yogurt Cups \$2
- Ice Cream \$2
- Premium "Power" Bars \$2
- Candy Bars/Gummi Bears -
- Cookies/Brownies -
- Fresh Fruit -
- Granola Bars/Cereal Bars -
- Mini Pastry/Danish/Muffins -
- Rice Krispy Treats -
- Yogurt Cups -

\*other options may be available upon request

## Savory Selections

Add. Cost

- Guacamole with Chips \$3
- Jerky \$3
- Hummus with Pita Chips \$2
- Hard Boiled Eggs -
- Kettle Potato Chips -
- Popcorn -
- Pretzels -
- Salsa with Chips -
- Trail Mix -

\*other options may be available upon request

Drury Plaza Hotel New Orleans

## Catering Options

Below is a list of our preferred catering vendors.

### **Pigeon Catering & Events**

[kpigeon@pigeonevents.com](mailto:kpigeon@pigeonevents.com)

☎ 504-262-0412

### **New Orleans Catering**

[NOCatering.com](http://NOCatering.com)

☎ 504-837-1075

## Audio-Visual Equipment\*

Royal Productions, our approved AV vendor, offers a full range of audio-visual services and technical support to enhance the meeting experience at the Drury Plaza Hotel New Orleans. The Royal Productions inventory assures the newest audio-visual technology and equipment is available to meet your sound, lighting, projection and computer meeting room needs. Their staff will be on property every day of your meeting to ensure all of your AV needs are met in both a friendly and professional manner. Please contact the Drury Plaza Hotel New Orleans AV Department with any questions at (504) 529-7800.

## Packages

### Projection Accessory Packages

- |   |       |
|---|-------|
| <b>Projection Accessories Package #1</b>  | \$200 |
| <ul style="list-style-type: none"> <li>- Tripod screen with skirt to accommodate room size.</li> <li>- Projection stand or cart with skirt.</li> <li>- All cabling, extension cords, drape and powerstrips, etc.</li> </ul> |       |

---
- |   |       |
|---|-------|
| <b>Projection Accessories Package #2</b>  | \$265 |
| <ul style="list-style-type: none"> <li>- Fast fold screen with black bottom valance.</li> <li>- Screen dress kit optional - add \$235.00.</li> <li>- Projection stand or cart with skirt.</li> <li>- All cabling, extension cords, drape and powerstrips, etc.</li> </ul> |       |

### LCD Packages

- |  |       |
|--|-------|
| <b>Computer Display Package #1</b>   | \$500 |
| <ul style="list-style-type: none"> <li>- HD LCD Projector (4,500 lumens).</li> <li>- Projection cart with drape.</li> <li>- Tripod screen with skirt to accommodate room size.</li> <li>- All cabling, extension cords, drape and powerstrips, etc.</li> </ul> |       |

---
- |   |       |
|---|-------|
| <b>Computer Display Package #2</b>  | \$900 |
| <ul style="list-style-type: none"> <li>- HD LCD Projector (6,500 lumens).</li> <li>- Projection cart with drape.</li> <li>- Screen dress kit.</li> <li>- Fast fold screen to accommodate room size.</li> <li>- All cabling, extension cords, drape and powerstrips, etc.</li> </ul> |       |

### Video Playback Packages

- |  |       |
|--|-------|
| <b>Video Playback Package #1</b>   | \$550 |
| <ul style="list-style-type: none"> <li>- DVD player.</li> <li>- 46" LCD Monitor.</li> <li>- 54" display cart with drape.</li> <li>- All cabling, extension cords, drape and powerstrips, etc.</li> </ul> |       |

---
- |   |       |
|---|-------|
| <b>Video Playback Package #2</b>  | \$550 |
| <ul style="list-style-type: none"> <li>- DVD player.</li> <li>- 4,500 lumens LCD.</li> <li>- Projection stand or cart with skirt.</li> <li>- Tripod screen with bottom drape.</li> <li>- Audio mixer.</li> <li>- All cabling, extension cords, drape and powerstrips, etc.</li> </ul> |       |

### Sound System Packages

- |  |       |
|--|-------|
| <b>Sound System Package #1</b>   | \$150 |
| <ul style="list-style-type: none"> <li>- Audience of up to 45 people.</li> <li>- Anchor Liberty speaker.</li> <li>- Speaker stand.</li> <li>- Wired podium microphone.</li> <li>- All cabling, extension cords, drape and powerstrips, etc.</li> </ul> |       |

---
- |  |       |
|--|-------|
| <b>Sound System Package #2</b>   | \$300 |
| <ul style="list-style-type: none"> <li>- Audience of up to 25 - 150 people.</li> <li>- 2 Mackie speakers.</li> <li>- 2 Ultimate support speaker stands.</li> <li>- 1 Mackie 6-channel mixer.</li> <li>- 1 wired podium microphone.</li> <li>- All cabling, extension cords, drape and powerstrips, etc.</li> </ul> |       |

### Additional Packages

- |   |      |
|---|------|
| <b>Podium Microphone Package</b>  | \$95 |
| <ul style="list-style-type: none"> <li>- In-house sound system.</li> <li>- Wired microphone.</li> <li>- 6-channel mixer.</li> <li>- Projection cart.</li> </ul> |      |

---
- |   |       |
|---|-------|
| <b>Wireless Microphone Package</b>  | \$200 |
| <ul style="list-style-type: none"> <li>- In-house sound system.</li> <li>- Wireless handheld or lavalier microphone.</li> <li>- 6-channel mixer.</li> <li>- Projection cart.</li> </ul> |       |

---
- |  |       |
|--|-------|
| <b>Podium Lighting Package</b>   | \$250 |
| <ul style="list-style-type: none"> <li>- 2 Leko lights.</li> <li>- 1 lighting tree.</li> </ul> |       |

---
- |  |       |
|--|-------|
| <b>Wedding Lighting Package</b>  | \$400 |
| <ul style="list-style-type: none"> <li>- 8 light LED up lights.</li> </ul> |       |

---
- |   |      |
|---|------|
| <b>iPad Accessories Package</b>   | \$95 |
| <ul style="list-style-type: none"> <li>- iPad adaptor and cable.</li> </ul> |      |

---
- |  |      |
|--|------|
| <b>Flipchart Package</b>   | \$65 |
| <ul style="list-style-type: none"> <li>- Flipchart easel stand.</li> <li>- Flipchart pad and markers.</li> </ul> |      |

\*All prices listed are per day, per room. There is a 1-hour minimum set-up charge and 1-hour minimum tear down charge on all orders. Additional set-up/dismantle technicians may be required, and at published rates. If you do not see a specific item needed to make your meeting a success, please call our Royal Productions office at the Drury Plaza Hotel New Orleans at (504) 529-7800.

## Standard AV Equipment

### Included

□ Wi-Fi	Free
□ Charging Station	Free

### Audio Equipment

□ 6-Channel Stereo Mixer	\$100
□ 16-Channel Stereo Mixer	\$150

No company or client is permitted to patch any audio equipment into the house sound system.

### Amplifiers / Speakers

□ Powered Speakers	\$100
□ Full-Range Speaker	\$150

### Microphone

□ Podium Microphone	\$45
□ Wired Lavalier or Handheld Microphone	\$45
□ Push-To-Talk Microphone	\$60
□ Push-To-Talk Base	\$100
□ Wireless Microphone/Lavalier	\$150
□ Wireless Microphone/Handheld	\$150

### Players / Recorders

□ CD Player	\$75
□ CD Recorder	\$225
□ DVD Player	\$75
□ MP3 Player	\$175
□ Video Camera	\$375
□ Video / Data Monitors	\$100
□ Camera Tripod	\$150

Contact Royal Productions to discuss other audio options:  
Audio recording your event | Line array concert quality sound systems  
Image magnification & projector blending | Multiple source switching & recording  
LED video walls & display | Custom & themed stage sets

### Computer & Video Monitors

□ 21" LCD Monitor	\$100
□ 32" LCD Monitor	\$250
□ 46" LCD Monitor	\$350
□ 55" LCD Monitor	\$450
□ 70" LCD Monitor	\$550
□ 72" Monitor Stand	\$125

### Computers & Printers

□ Laptop Computer	\$165
□ Desktop Computer	\$165
□ Printer <i>laser black &amp; white, network capable</i>	\$1000

Color printers available. Call for details.

## Video / Computer Projection Equipment

□ Projector Breakout Room <i>4,500 lumens</i>	\$450
□ Projector General Session <i>6,500 lumens</i>	\$650
□ HD Projector	\$1,200

Contact Royal Productions to discuss other projection, such as:  
Multiple screens, widescreen & HD projection available.

### Tripod Screen & Projector Fast Fold Screens

□ Tripod Screen	\$95
□ 6' x 8'	\$150
□ 7.5' x 10'	\$200
□ 9' x 12'	\$250
□ Screen Dress Kit <i>optional</i>	\$150

### Event Support Equipment

□ Flipchart with Standard Paper & Markers	\$65
□ Laser Pointer	\$20
□ Projector Stand	\$25
□ Speaker Timer	\$75
□ LTI Laptop Audio Interface	\$45
□ Wireless Mouse	\$65
□ 25' Extension Cord with Powerstrip	\$20

### Lighting Equipment

□ Leko Lights <i>various degree</i>	\$50
□ Par 64 Lights <i>various degree</i>	\$50
□ LED Lights	\$60
□ Lighting Trees	\$150
□ 4-Channel Lighting Dimmer	\$150
□ 4-Channel Lighting Controller	\$150
□ Follow Spot Light <i>operator required</i>	\$150

Contact Royal Productions to discuss additional lighting options for your event.

### Runoff Drape

□ 6' x 16' Black Drape <i>per running foot</i>	\$18
--	------

Other drape sizes and colors available upon request.

### Set Up & Dismantle Technicians

Technicians are available at the following rates:

□ Monday - Friday 6:00 AM - Midnight	from \$85
□ Monday - Friday Midnight - 6:00 AM	\$127.50 / hr
□ Saturday & Sunday 6:00 AM - Midnight	\$127.50 / hr
□ Saturday & Sunday Midnight - 6:00 AM	\$127.50 / hr

Operators are available at the following rates:

□ Monday - Sunday 6:00 AM - Midnight	\$105 / hr
--------------------------------------	------------

5-hour minimum on all operator calls.