

Drury Plaza Hotel Cleveland Downtown

## DRURY PLAZA HOTEL CLEVELAND | DOWNTOWN

1380 East 6th Street, Cleveland, OH 44114

Our team is ready to deliver prompt, personalized service to ensure your event will make a big impact. Customize your meeting with flexible catering and audio-visual options, and enjoy affordable pricing without hidden fees.

### MEETING SPACE

- 3 total meeting rooms plus prefunction space
- 3,900+ sq ft of flexible meeting room space
  - Accommodates up to 250 in largest capacity space

### ROOM TYPES

- 189 spacious guestrooms & two-room suites
- 84 deluxe king rooms
  - 86 deluxe double queen rooms
  - 19 deluxe two-room suites

### AMENITIES



Free  
Hot Breakfast



Free  
5:30 Kickback®



Free  
Wi-Fi

The Teachers' Lounge - *Open late, every night*  
24-hour business & fitness centers  
Indoor pool & whirlpool  
Guest market available  
Guest laundry & same day dry cleaning (Mon - Fri) available  
Microwave & refrigerator in every room  
Drury Rewards® loyalty program

### PARKING

On-site parking available for a nightly fee

**FOR MORE INFORMATION ON PLANNING YOUR NEXT EVENT,  
PLEASE CONTACT OUR SALES TEAM AT:**

**E** Groups@DruryHotels.com

**P** 800-436-1169



Drury Plaza Hotel Cleveland Downtown

## Capacities & Dimensions

We offer a variety of customizable set-up options to make your next event a success.

Meeting Room	Dimensions	Sq Ft	Banquet	Conference	Theater	Classroom	U-Shape
Great Lakes Ballroom	45' x 50'	2,458	180	—	250	135	52
Cuyahoga	43' x 25'	1,075	80	24	110	64	28
Boardroom	27' x 17'	459	32	26	55	24	—

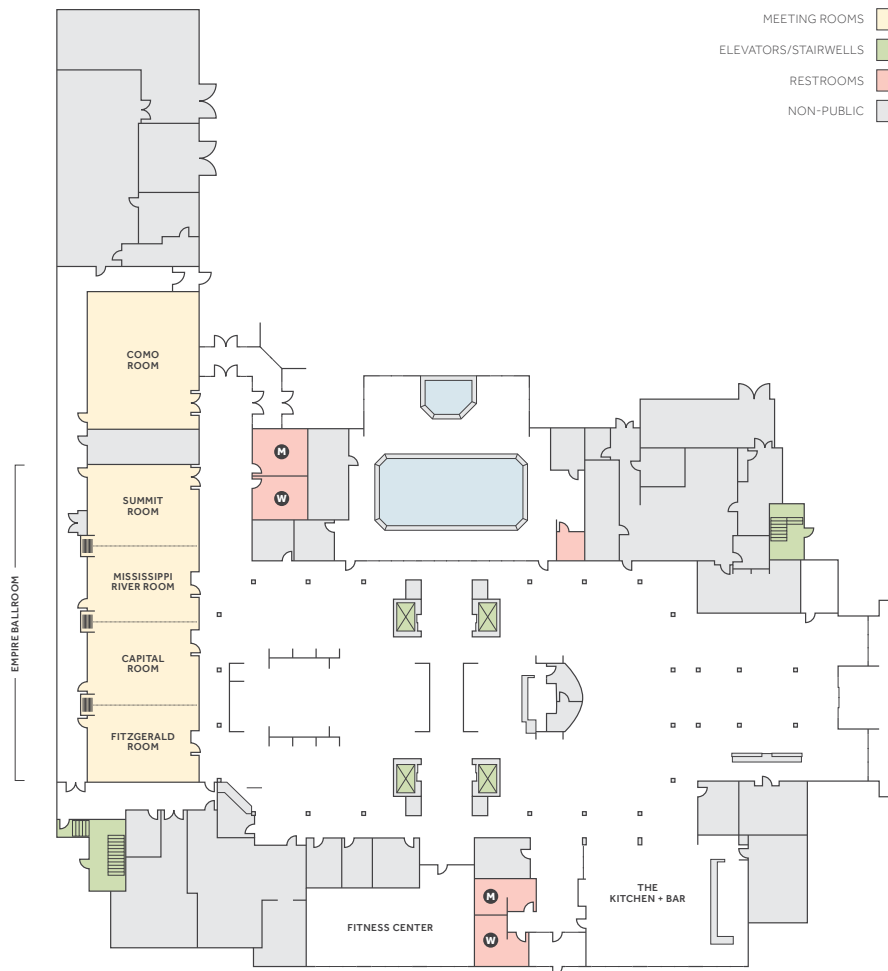

Drury Plaza Hotel Cleveland Downtown

## Break Packages

We offer all-day beverage service, as well as AM or PM breaks, so your meeting never runs out of steam.

**No food & beverage minimum is required.**

## Beverage Breaks

All day service - will refresh as needed; 10 person minimum.

- **Deluxe** **\$16 / person**  
*"Standard" and "Basic" packages (no bulk iced tea), plus...*
  - Premium Bottled Water/Sparkling Water
  - Assorted/Herbal Teas
- **Standard** **\$13 / person**  
*"Basic" package, plus...*
  - Assorted Soda Cans
  - Bottled Water
- **Basic** **\$10 / person**
  - Regular/Decaf Coffee & Hot Tea
  - Iced Tea (bulk) and Infused Water (bulk)

## Recharge Food Breaks

Pricing valid with purchase of Beverage Break; 45 minute service; 10 person minimum; select items may have a per person upcharge as indicated (\*).

- **Sweet & Savory** **\$17 / person**  
 Mix & match up to four (4) selections from our "Sweet" or "Savory" list.  
*Additional selections \$2 / person.*
- **Sweet Only** **\$11 / person**  
 Mix & match two (2) selections from our "Sweet" list.  
*Additional selections \$2 / person.*
- **Savory Only** **\$11 / person**  
 Mix & match two (2) selections from our "Savory" list.  
*Additional selections \$2 / person.*

## Other Food Options

- **Drury's Hot Breakfast** **\$10.99 / person**  
 A variety of hot food options, cereal, pastries, bagels and more.  
 Served daily - 6:00 - 9:30 am Monday - Friday & 7:00 - 10:00 am Saturday & Sunday - in the main dining area only.
- **Drury's 5:30 Kickback®** **\$12.99 / person**  
 Rotating menu of hot food options, hearty soups, healthy salads and more.  
 Served nightly - 5:30 - 7:00 pm - in the main dining area only.  
*Alcoholic beverages not included for non-hotel guests.*

*Prices are subject to change and are exclusive of service charge and local sales tax.*

## A La Carte Beverages

Add. Cost

- Coffee - 1.5 gal. (regular or decaf) \$48
- Energy Drinks (i.e. Red Bull) (ea) \$5
- Premium or Sparkling Bottled Water (ea) \$5
- Black & Herbal Tea with Hot Water (ea) \$3
- Soda/Juice/Water (by the can/bottle) (ea) \$3

## Sweet Selections

Add. Cost

- Greek Yogurt Cups \$2
- Ice Cream \$2
- Premium "Power" Bars \$2
- Candy Bars/Gummi Bears -
- Cookies/Brownies -
- Fresh Fruit -
- Granola Bars/Cereal Bars -
- Mini Pastry/Danish/Muffins -
- Rice Krispy Treats -
- Yogurt Cups -

*\*other options may be available upon request*

## Savory Selections

Add. Cost

- Guacamole with Chips \$3
- Jerky \$2
- Hummus with Pita Chips \$2
- Hard Boiled Eggs -
- Kettle Potato Chips -
- Popcorn -
- Pretzels -
- Salsa with Chips -
- Trail Mix -

*\*other options may be available upon request*

Drury Plaza Hotel Cleveland Downtown

## Catering Options

Below is a list of our preferred catering vendors.

### **Carmine's Steak House**

[LombardosRestaurants.com](http://LombardosRestaurants.com)

**P** 123-456-7890

Carmine's menu includes a variety of aged beef and handcut chops, fresh seafood, chicken entrees and delicious housemade desserts.

### **Angelo's Taverna**

[LombardosRestaurants.com](http://LombardosRestaurants.com)

**P** 123-456-7890

Angelo's Taverna features our third generation Italian recipes as well as great steaks, gourmet thin crust pizza, and excellent sandwiches.

Drury Plaza Hotel Cleveland Downtown

## Audio-Visual Equipment\*

Drury Hotels proudly offers a selection of onsite audio-visual equipment available to rent. If your audio-visual request cannot be accommodated using our onsite equipment, our National Group Sales Coordinators can assist in obtaining the additional equipment for your meeting.

ITEM	PRICE
□ High-Speed Wi-Fi	FREE
□ Charging Station	FREE
□ AV Support Package	
□ LCD Projector & Screen	\$200 / day
□ AV Cart	\$500 / week
□ 2 Flipcharts with Markers	
□ House Sound Package	
□ Handheld Microphone	\$100 / day
□ Access to House Sound System	
□ LCD Projector	\$250
□ Wireless Lapel or Handheld Microphone	\$100
□ Polycom Speaker Phone	\$50
□ Flipchart with Easel & Markers	\$20
□ 47" TV, DVD Player	\$125
□ Powerstrips/Extension Cords	\$10 / per

\* For the convenience of meeting planners, groups may bring their own audio visual equipment if desired. If the group requires equipment not carried by the hotel, equipment will be ordered from an approved local AV supplier and the customer will be billed the suppliers price through the hotel on the Banquet Event Order. AV equipment and pricing are subject to change. Please contact our Group Sales Department at 1-800-436-1169 for complete details.

All AV equipment includes an extension cord and powerstrip. Pricing and available equipment are subject to change. Listed AV is priced per day and is exclusive of tax.