

Drury Plaza Hotel Nashville Downtown

## DRURY PLAZA HOTEL NASHVILLE | DOWNTOWN

300 Korean Veterans Boulevard, Nashville, TN 37201

Our team is ready to deliver prompt, personalized service to ensure your event will make a big impact. Experience *Meetings with More* value featuring free Wi-Fi in meeting rooms, no food and beverage minimums, flexible cancellation policies, and our best-in-class free amenities for hotel guests.

### MEETING SPACE

8 meeting rooms

- 7,715+ sq ft of meeting room space
- Accommodates up to 280 in largest capacity space

### ROOM TYPES

389 spacious guestrooms & two-room suites

- 182 deluxe king rooms
- 169 deluxe double queen rooms
- 38 deluxe two-room suites

### AMENITIES



Free  
Hot Breakfast



Free  
5:30 Kickback®



Free  
Wi-Fi

The Kitchen + Bar @ SOBRO - *located on the eighth floor*  
24-hour business & fitness centers  
Indoor/outdoor pool & whirlpool  
Guest market available  
Guest laundry & same day dry cleaning (Mon - Fri) available  
Microwave & refrigerator in every room  
Drury Rewards® loyalty program

### PARKING

On-site parking available for a \$42.00 nightly fee

**FOR MORE INFORMATION ON PLANNING YOUR NEXT EVENT,  
PLEASE CONTACT OUR SALES TEAM:**

**Mackenzie Nelson**

**E** Mackenzie.Nelson@DruryHotels.com

**P** 615-986-6484

**Tyler Eckenrod**

**E** Tyler.Eckenrod@DruryHotels.com

**P** 615-986-3530



Drury Plaza Hotel Nashville Downtown

## Capacities & Dimensions

We offer a variety of customizable set-up options to make your next event a success.

Room	Dimensions	Sq Ft	Banquet Capacity*	Conference Capacity*	Theater Capacity*	Classroom Capacity*	U-Shape Capacity*	Reception Capacity*
Belmont Ballroom	62' x 38'	2,300	160	48	280	165	60	230
Old Hickory	35' x 19'	665	40	24	96	36	30	67
Charlotte	30' x 27'	775	40	24	90	48	21	78
Belle Meade (Combined)	30' x 48'	1,450	88	36	160	96	45	145
Belle Meade A	30' x 24'	725	48	18	96	48	21	73
Belle Meade B	30' x 24'	725	48	18	96	48	21	73
Tyne	45' x 28'	1,250	80	30	139	54	39	125
Woodmont	36' x 21'	750	40	24	96	36	30	75
Granny White Board Room	21' x 25'	525	--	12	--	--	--	--
Guest Dining	--	4,822	222	--	--	--	--	--
Outdoor Terrace	--	1,567	40	--	--	--	--	--
North Pre-Function	32' x 20'	640	--	--	--	--	--	64
South Pre-Function	63' x 20'	1,200	--	--	--	--	--	120

\* other capacities/arrangements are available, call for details.

\*\*Meeting Room Space: 7,715 sq ft

\*\*Flexible Meeting Space including Public & Pre-function: 16,034 sq ft

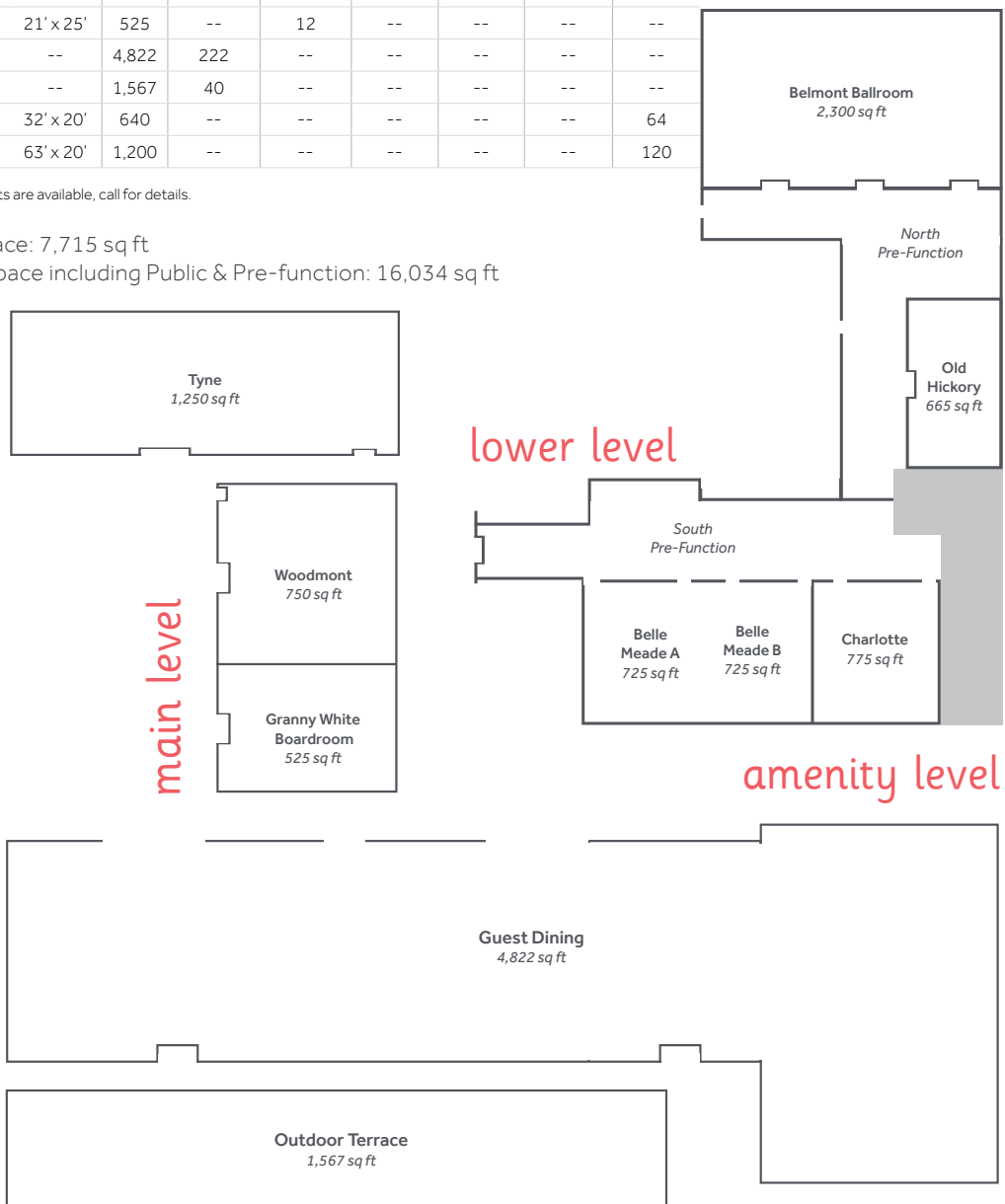

Drury Plaza Hotel Nashville Downtown

## Break Packages

We offer all-day beverage service, as well as AM or PM breaks, so your meeting never runs out of steam.

**No food & beverage minimum is required.**

## Beverage Breaks

All-day service - will refresh as needed; 10 person minimum.

- **Deluxe** **\$17 / person**  
*"Standard" and "Basic" packages (no carafes of iced tea), plus...*
  - Premium Bottled Water/Sparkling Water
  - Assorted/Herbal Teas
- **Standard** **\$14 / person**  
*"Basic" package, plus...*
  - Assorted Soda Cans
  - Bottled Water
- **Basic** **\$12 / person**
  - Regular/Decaf Coffee & Hot Tea
  - Carafes of Iced Tea and Infused Water

## Recharge Food Breaks

Pricing valid with purchase of Beverage Break; 45 minute service; 10 person minimum; select items may have a per person upcharge as indicated (\*).

- **Sweet & Savory** **\$18 / person**  
 Mix & match up to four (4) selections from our "Sweet" or "Savory" list.  
*Additional selections \$2 / person.*
- **Sweet Only** **\$12 / person**  
 Mix & match two (2) selections from our "Sweet" list.  
*Additional selections \$2 / person.*
- **Savory Only** **\$12 / person**  
 Mix & match two (2) selections from our "Savory" list.  
*Additional selections \$2 / person.*

## Other Food Options

- **Drury's Hot Breakfast** **\$10.99 / person**  
 A variety of hot food options, cereal, pastries, bagels and more.  
 Served daily - 6:00 - 9:30 am Monday - Friday & 7:00 - 10:00 am Saturday & Sunday - in the main dining area only.
- **Drury's 5:30 Kickback®** **\$12.99 / person**  
 Rotating menu of hot food options, hearty soups, healthy salads and more.  
 Served nightly - 5:30 - 7:00 pm - in the main dining area only.  
*Alcoholic beverages not included for non-hotel guests.*

## A La Carte Beverages

Add. Cost

- Coffee - 1.5 gal. (regular or decaf) \$54
- Energy Drinks (i.e. Red Bull) (ea) \$6
- Premium or Sparkling Bottled Water (ea) \$5
- Black & Herbal Tea with Hot Water (ea) \$3
- Soda/Water (by the can/bottle) (ea) \$3

## Sweet Selections

Add. Cost

- Greek Yogurt Cups \$3
- Ice Cream \$3
- Premium "Power" Bars \$3
- Candy Bars -
- Cookies -
- Brownies -
- Whole Fresh Fruit -
- Granola Bars/Cereal Bars -
- Mini Pastries -
- Danishes -
- Muffins -
- Rice Krispy Treats -
- Yogurt Cups -

\* other options may be available upon request

## Savory Selections

Add. Cost

- Guacamole with Chips \$3
- Jerky \$3
- Hummus with Pita Chips \$2
- Trail Mix \$2
- Hard Boiled Eggs -
- Kettle Potato Chips -
- Smartfood® White Cheddar Popcorn -
- Rold Gold® Pretzels -
- Salsa with Chips -

\* other options may be available upon request

Drury Plaza Hotel Nashville Downtown

## Catering Options

Below is our preferred catering vendor.

### **Dream Events & Catering**

[DreamEventsandCatering.com](http://DreamEventsandCatering.com)

☎ 615-259-0848

Dream Events & Catering is a full-service event and catering company. Whether the event is large or small, social or corporate, Dream Events & Catering's wide range of event and catering services can be tailored to fit unique needs. As all-inclusive and full-service as needed, from event planning & florals to entertainment, rentals, and delicious food. With experienced event specialists and a full culinary team, the Dream Team is here to create an event that is dreamy & delicious!

Drury Plaza Hotel Nashville Downtown

## Audio-Visual Equipment\*

Drury Hotels proudly offers a selection of onsite audio-visual equipment available to rent. If your audio-visual request cannot be accommodated using our onsite equipment, our National Group Sales Coordinators can assist in obtaining the additional equipment for your meeting.

ITEM	PRICE
□ Wi-Fi	FREE
□ AV Support Package	
□ LCD Projector & Screen	\$350 / day
□ AV Cart**	
□ 2 Flipcharts with Markers	
□ Executive AV Support Package	
□ LCD Projector & Screen	\$500 / day
□ AV Cart	
□ Standing Podium with Choice of Microphone	
□ Wireless Presenter with Laser Pointer	
□ Wireless Lapel or Handheld Microphone	\$150
□ Polycom Speaker Phone	\$150
□ Flipchart with Easel & Markers	\$60
□ 47" TV, DVD Player	\$200
□ Powerstrips/Extension Cords	\$25 / per
□ Confidence Monitor	\$200
□ Podium without Microphone	\$100
□ Podium with Microphone	\$125
□ Stage	\$125 / per section

\* For the convenience of meeting planners, groups may bring their own audio visual equipment if desired. If the group requires equipment not carried by the hotel, equipment will be ordered from an approved local AV supplier and the customer will be billed the suppliers price through the hotel on the Banquet Event Order. AV equipment and pricing are subject to change. Please contact our Group Sales Department at 1-800-436-1169 for complete details.

Pricing shown is per day and does not include tax or service fee unless otherwise noted. All AV equipment comes with an extension cord and power strip.

\*\* AV cart provided when projector is not ceiling mounted.