

Drury Plaza Hotel New Orleans

## DRURY PLAZA HOTEL NEW ORLEANS

820 Poydras Street, New Orleans, LA 70112

Our team is ready to deliver prompt, personalized service to ensure your event will make a big impact. Experience *Meetings with More* value featuring free Wi-Fi in meeting rooms, no food and beverage minimums, flexible cancellation policies, and our best-in-class free amenities for hotel guests.

### MEETING SPACE

6 meeting rooms plus prefunction space

- 6,150 sq ft of flexible meeting room space
- Accommodates up to 500 in largest capacity space

### ROOM TYPES

214 spacious guestrooms & two-room suites

- 72 deluxe king bed rooms
- 61 deluxe double queen rooms
- 81 deluxe two-room suites

### AMENITIES



Free  
Hot Breakfast



Free  
5:30 Kickback®



Free  
Wi-Fi

The Kitchen + Bar @ Cumberland Switch - *Open late, every night*  
24-hour business & fitness centers  
Heated outdoor courtyard pool & whirlpool  
Guest market available  
Guest laundry & same day dry cleaning (Mon - Fri) available  
Microwave & refrigerator in every room  
Drury Rewards® loyalty program

### PARKING

On-site covered parking available for a nightly fee

**FOR MORE INFORMATION ON PLANNING YOUR NEXT EVENT,  
PLEASE CONTACT CHRISTY BORREL AT:**

**E** [Christy.Borrel@DruryHotels.com](mailto:Christy.Borrel@DruryHotels.com)

**P** 504-380-8326



Drury Plaza Hotel New Orleans

## Capacities & Dimensions

We offer a variety of customizable set-up options to make your next event a success.

Meeting Room	Dimensions	Sq Ft	Banquet	Conference	Theater	Classroom	U-Shape
Grand Ballroom	94' x 64'	5,538	350	80	500	300	60
Ballroom A	29' x 64'	1,802	125	40	150	100	30
Ballroom B	34' x 64'	2,023	150	40	200	110	30
Ballroom C	30' x 64'	1,713	125	40	150	100	40
Ballroom AB	63' x 64'	3,825	180	60	300	200	40
Ballroom BC	64' x 64'	3,736	180	60	300	200	40
Canal	21' x 30'	570	40	18	50	30	14
Poydras	20' x 30'	591	50	20	16	35	15
Carondelet	20' x 30'	552	40	18	50	30	14
Orleans	18' x 34'	612	50	20	50	35	15

- MEETING ROOMS
- ELEVATORS/STAIRWELLS
- RESTROOMS
- NON-PUBLIC

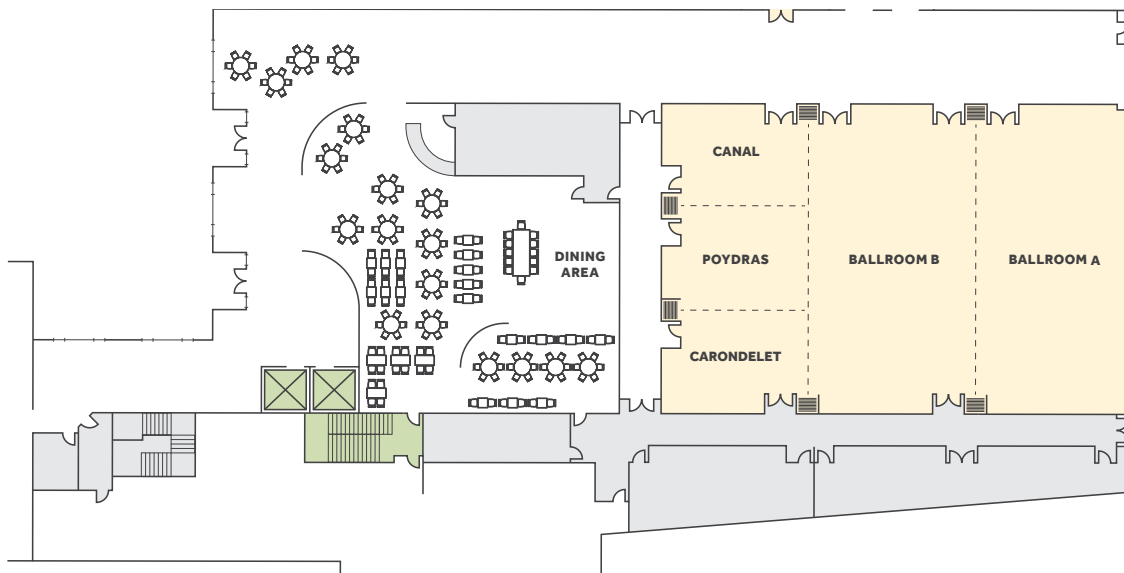

Drury Plaza Hotel New Orleans

## Break Packages

We offer all-day beverage service, as well as AM or PM breaks, so your meeting never runs out of steam.

**No food & beverage minimum is required.**

## Beverage Breaks

All-day service - will refresh as needed; 10 person minimum.

- **Deluxe** **\$ 20 / person**  
*"Standard" and "Basic" packages (no carafes of iced tea), plus...*
  - Premium Bottled Water/Sparkling Water
  - Assorted/Herbal Teas
- **Standard** **\$17 / person**  
*"Basic" package, plus...*
  - Assorted Soda Cans
  - Bottled Water
- **Basic** **\$15 / person**
  - Regular/Decaf Coffee & Hot Tea
  - Carafes of Iced Tea and Infused Water

## Recharge Food Breaks

Pricing valid with purchase of Beverage Break; 45 minute service; 10 person minimum; select items may have a per person upcharge as indicated (\*).

- **Sweet & Savory** **\$20 / person**  
 Mix & match up to four (4) selections from our "Sweet" or "Savory" list.  
*Additional selections \$2 / person.*
- **Sweet Only** **\$15 / person**  
 Mix & match two (2) selections from our "Sweet" list.  
*Additional selections \$2 / person.*
- **Savory Only** **\$15 / person**  
 Mix & match two (2) selections from our "Savory" list.  
*Additional selections \$2 / person.*

## Other Food Options

60 minute service.

- **Continental Breakfast** **\$25 / person**  
 Assorted Muffins and Bagels with Butter & Preserves; Assorted Danish;  
 Fresh Whole Fruit, Seasonal; Individual Yogurt Cups with Fresh Granola;  
 Orange Juice; Freshly Brewed Regular Coffee; Freshly Brewed Decaffeinated  
 Coffee; Hot Tea
- **Breakfast Buffet** **\$28 / person**  
 Scrambled Eggs; Breakfast Potatoes; Sausage; Biscuits with Gravy; Whole  
 Fresh Fruit, Seasonal; Assorted Muffins and Bagels with Butter & Preserves;  
 Individual Yogurt Cups with Fresh Granola; Orange Juice; Freshly Brewed  
 Regular Coffee; Freshly Brewed Decaffeinated Coffee; Hot Tea

## A La Carte

Add. Cost

- Coffee - 1.5 gal. (regular or decaf) \$70
- Energy Drinks (i.e. Red Bull) (ea) \$6
- Premium or Sparkling Bottled Water (ea) \$6
- Black & Herbal Tea with Hot Water (ea) \$5
- Soda/Water (by the can/bottle) (ea) \$3
- Cookies OR Brownies. (dozen) \$60

## Sweet Selections

Add. Cost

- Greek Yogurt Cups \$5
- Ice Cream \$3
- Premium "Power" Bars \$4
- Candy Bars \$3
- Cookies -
- Brownies -
- Whole Fresh Fruit -
- Granola Bars/Cereal Bars -
- Mini Pastries -
- Danishes -
- Muffins -
- Rice Krispy Treats -
- Yogurt Cups -

\* other options may be available upon request

## Savory Selections

Add. Cost

- Guacamole with Chips \$10
- Jerky \$3
- Hummus with Pita Chips \$10
- Trail Mix \$4
- Hard Boiled Eggs -
- Kettle Potato Chips -
- Smartfood® White Cheddar Popcorn -
- Rold Gold® Pretzels -
- Salsa with Chips -

\* other options may be available upon request

Drury Plaza Hotel New Orleans

## Catering Options

Below is a list of our preferred catering vendors.

### **Pigeon Catering & Events**

[kpigeon@pigeonevents.com](mailto:kpigeon@pigeonevents.com)

P 504-262-0412

### **New Orleans Catering**

[NOCatering.com](http://NOCatering.com)

P 504-837-1075

## Audio-Visual Equipment\*

Royal Productions, our approved AV vendor, offers a full range of audio-visual services and technical support to enhance the meeting experience at the Drury Plaza Hotel New Orleans. The Royal Productions inventory assures the newest audio-visual technology and equipment is available to meet your sound, lighting, projection and computer meeting room needs. Their staff will be on property every day of your meeting to ensure all of your AV needs are met in both a friendly and professional manner. Please contact the Drury Plaza Hotel New Orleans AV Department with any questions at (504) 529-7800.

### Packages PRICE

<ul style="list-style-type: none"> <li> <b>□ Projection Accessories Package</b> <span style="float: right;">\$250</span> <ul style="list-style-type: none"> <li>- Tripod screen with skirt to accommodate room size.</li> <li>- Projection stand or cart with skirt.</li> <li>- All cabling, extension cords, drape and powerstrips, etc.</li> </ul> </li> </ul>
<ul style="list-style-type: none"> <li> <b>□ Computer Display Package</b> <span style="float: right;">\$500</span> <ul style="list-style-type: none"> <li>- HD LCD Projector (4,500 lumens).</li> <li>- Projection cart with drape.</li> <li>- Tripod screen with skirt to accommodate room size.</li> <li>- All cabling, extension cords, drape and powerstrips, etc.</li> </ul> </li> </ul>
<ul style="list-style-type: none"> <li> <b>□ Video Playback Package</b> <span style="float: right;">\$550</span> <ul style="list-style-type: none"> <li>- DVD player.</li> <li>- 46" LCD Monitor.</li> <li>- 54" display cart with drape.</li> <li>- All cabling, extension cords, drape and powerstrips, etc.</li> </ul> </li> </ul>
<ul style="list-style-type: none"> <li> <b>□ Wireless Microphone Package</b> <span style="float: right;">\$200</span> <ul style="list-style-type: none"> <li>- In-house sound system.</li> <li>- Wireless handheld or lavalier microphone.</li> <li>- 6-channel mixer.</li> <li>- Projection cart.</li> </ul> </li> </ul>
<ul style="list-style-type: none"> <li> <b>□ Flipchart Package</b> <span style="float: right;">\$65</span> <ul style="list-style-type: none"> <li>- Flipchart easel stand.</li> <li>- Flipchart pad and markers.</li> </ul> </li> </ul>

### Standard AV Equipment PRICE

<ul style="list-style-type: none"> <li> <b>□ Wi-Fi</b> <span style="float: right;">Free</span> </li> <li> <b>□ Charging Station</b> <span style="float: right;">Free</span> </li> </ul>
---

### Audio Equipment

<ul style="list-style-type: none"> <li> <b>□ 6-Channel Stereo Mixer</b> <span style="float: right;">\$100</span> </li> <li> <b>□ 16-Channel Stereo Mixer</b> <span style="float: right;">\$150</span> </li> </ul>
---

*No company or client is permitted to patch any audio equipment into the house sound system.*

### Microphone

<ul style="list-style-type: none"> <li> <b>□ Wireless Microphone/Lavalier</b> <span style="float: right;">\$150</span> </li> <li> <b>□ Wireless Microphone/Handheld</b> <span style="float: right;">\$150</span> </li> </ul>
--

### Event Support Equipment

<ul style="list-style-type: none"> <li> <b>□ Flipchart with Standard Paper &amp; Markers</b> <span style="float: right;">\$65</span> </li> <li> <b>□ Laser Pointer</b> <span style="float: right;">\$20</span> </li> <li> <b>□ Projector Stand</b> <span style="float: right;">\$25</span> </li> <li> <b>□ Speaker Timer</b> <span style="float: right;">\$75</span> </li> <li> <b>□ LTI Laptop Audio Interface</b> <span style="float: right;">\$45</span> </li> <li> <b>□ Wireless Mouse</b> <span style="float: right;">\$65</span> </li> <li> <b>□ 25' Extension Cord with Powerstrip</b> <span style="float: right;">\$20</span> </li> </ul>
---

### Computer & Video Monitors

<ul style="list-style-type: none"> <li> <b>□ 21" LCD Monitor</b> <span style="float: right;">\$100</span> </li> <li> <b>□ 32" LCD Monitor</b> <span style="float: right;">\$250</span> </li> <li> <b>□ 46" LCD Monitor</b> <span style="float: right;">\$350</span> </li> <li> <b>□ 55" LCD Monitor</b> <span style="float: right;">\$450</span> </li> <li> <b>□ 70" LCD Monitor</b> <span style="float: right;">\$550</span> </li> <li> <b>□ 72" Monitor Stand</b> <span style="float: right;">\$125</span> </li> </ul>
--

### Computers & Printers

<ul style="list-style-type: none"> <li> <b>□ Laptop Computer</b> <span style="float: right;">\$165</span> </li> <li> <b>□ Printer <i>laser black &amp; white, network capable</i></b> <span style="float: right;">\$1000</span> </li> </ul>
---

*Color printers available. Call for details.*

\* All prices listed are per day, per room. There is a 1-hour minimum set-up charge and 1-hour minimum tear down charge on all orders. Additional set-up/dismantle technicians may be required, and at published rates. If you do not see a specific item needed to make your meeting a success, please call our Royal Productions office at the Drury Plaza Hotel New Orleans at (504) 529-7800.