

Drury Plaza Hotel Broadview Wichita

DRURY PLAZA HOTEL BROADVIEW | WICHITA

400 West Douglas Avenue, Wichita, KS 67202

Our team is ready to deliver prompt, personalized service to ensure your event will make a big impact. Experience *Meetings with More* value featuring free Wi-Fi in meeting rooms, no food and beverage minimums, flexible cancellation policies, and our best-in-class free amenities for hotel guests.

MEETING SPACE

7 meeting rooms

- 12,000+ sq ft of meeting room space
- Accommodates up to 860 in largest capacity space

ROOM TYPES

200 spacious guestrooms & two-room suites

- 93 deluxe king rooms
- 83 deluxe double queen rooms
- 24 deluxe two-room suites

AMENITIES FOR HOTEL GUESTS



Free
Hot Breakfast



Free
5:30 Kickback®



Free
Wi-Fi

24-hour business & fitness centers

Indoor pool & whirlpool

Guest market available

Free 24-Hour Airport Shuttle

Guest laundry & same day dry cleaning (Mon - Fri) available

Microwave & refrigerator in every room

Drury Rewards® loyalty program

PARKING

On-site parking available for a nightly fee

**FOR MORE INFORMATION ON PLANNING YOUR NEXT EVENT,
PLEASE CONTACT OUR SALES TEAM AT:**

E Groups@DruryHotels.com

P 800-436-1169



Drury Plaza Hotel Broadview Wichita

Capacities & Dimensions

We offer a variety of customizable set-up options to make your next event a success.

Room	Dimensions	Sq. Ft.	Banquet	Conference	Theater	Classroom	U-Shape
Bosin Ballroom	156' x 59'	9,204	600	--	860	450	--
Bosin 1	52' x 59'	3,068	200	60	250	150	45
Bosin 2	52' x 59'	3,068	200	60	250	150	45
Bosin 3	52' x 59'	3,068	200	60	250	150	45
Station Ballroom	52' x 38'	1,976	120	44	175	100	34
Station 1	27' x 38'	1,026	60	32	120	50	24
Station 2	25' x 38'	950	60	32	90	46	24
Siedhoff Salon	33' x 21'	693	40	25	70	30	20
Viola Boardroom	22' x 19'	418	--	10	--	--	--
Waco Lobby	117' x 49'	5,733	250	--	--	--	--
River View & South Lobby	--	4,763	250	--	--	--	--
Mezzanine	--	4,431	160	--	--	--	--

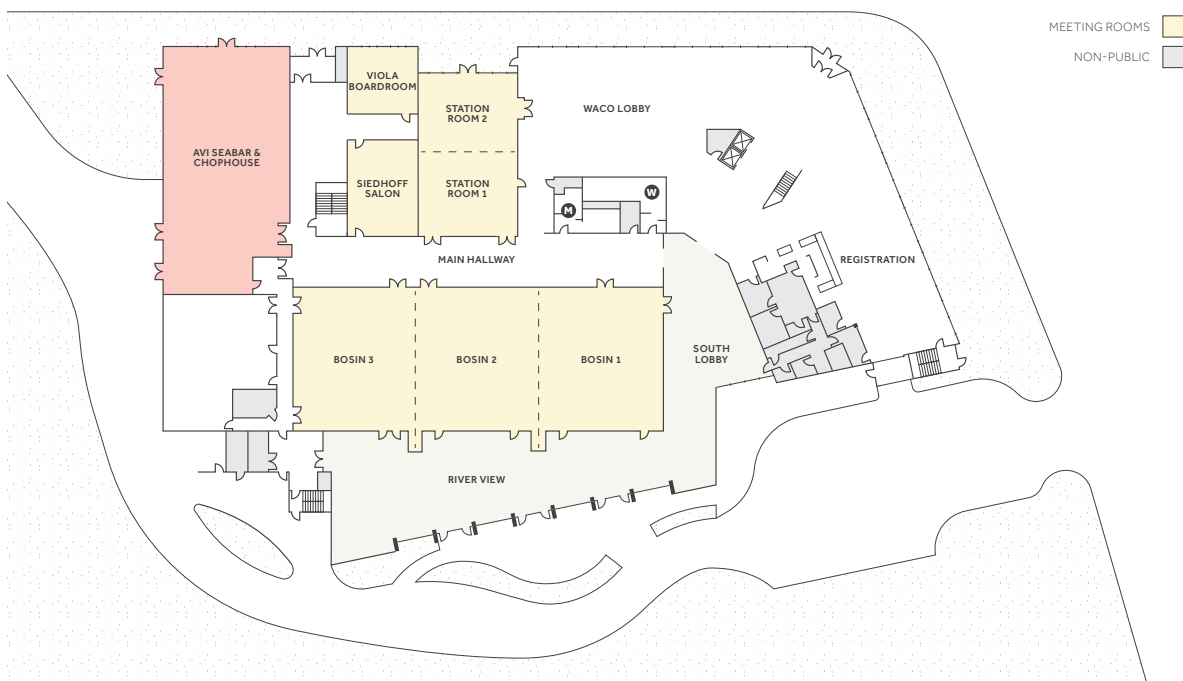

Drury Plaza Hotel Broadview Wichita

Break Packages

We offer all-day beverage service, as well as AM or PM breaks, so your meeting never runs out of steam.

No food & beverage minimum is required.

Beverage Breaks

All-day service - will refresh as needed; 10 person minimum.

- **Deluxe** **\$17 / person**
"Standard" and "Basic" packages (no carafes of iced tea), plus...
 - Premium Bottled Water/Sparkling Water
 - Assorted/Herbal Teas
- **Standard** **\$14 / person**
"Basic" package, plus...
 - Assorted Soda Cans
 - Bottled Water
- **Basic** **\$12 / person**
 - Regular/Decaf Coffee & Hot Tea
 - Carafes of Iced Tea and Infused Water

Recharge Food Breaks

Pricing valid with purchase of Beverage Break; 45 minute service; 10 person minimum; select items may have a per person upcharge as indicated (*).

- **Sweet & Savory** **\$18 / person**
 Mix & match up to four (4) selections from our "Sweet" or "Savory" list.
Additional selections \$2 / person.
- **Sweet Only** **\$12 / person**
 Mix & match two (2) selections from our "Sweet" list.
Additional selections \$2 / person.
- **Savory Only** **\$12 / person**
 Mix & match two (2) selections from our "Savory" list.
Additional selections \$2 / person.

Other Food Options

- **Drury's Hot Breakfast** **\$10.99 / person**
 A variety of hot food options, cereal, pastries, bagels and more.
 Served daily - 6:00 - 9:30 am Monday - Friday & 7:00 - 10:00 am Saturday & Sunday - in the main dining area only.
- **Drury's 5:30 Kickback®** **\$12.99 / person**
 Rotating menu of hot food options, hearty soups, healthy salads and more.
 Served nightly - 5:30 - 7:00 pm - in the main dining area only.
Alcoholic beverages not included for non-hotel guests.

A La Carte Beverages

Add. Cost

- Coffee - 1.5 gal. (regular or decaf) \$54
- Energy Drinks (i.e. Red Bull) (ea) \$6
- Premium or Sparkling Bottled Water (ea) \$5
- Black & Herbal Tea with Hot Water (ea) \$3
- Soda/Water (by the can/bottle) (ea) \$3

Sweet Selections

Add. Cost

- Greek Yogurt Cups \$3
- Ice Cream \$3
- Premium "Power" Bars \$3
- Candy Bars -
- Cookies -
- Brownies -
- Whole Fresh Fruit -
- Granola Bars/Cereal Bars -
- Mini Pastries -
- Danishes -
- Muffins -
- Rice Krispy Treats -
- Yogurt Cups -

* other options may be available upon request

Savory Selections

Add. Cost

- Guacamole with Chips \$3
- Jerky \$3
- Hummus with Pita Chips \$2
- Trail Mix \$2
- Hard Boiled Eggs -
- Kettle Potato Chips -
- Smartfood® White Cheddar Popcorn -
- Rold Gold® Pretzels -
- Salsa with Chips -

* other options may be available upon request

Drury Plaza Hotel Broadview Wichita

Catering Options

Below is a list of our preferred catering vendors.

Corporate Caterers of Wichita

P 316-264-9167

E Info@CorporateCaterersofWichita.com

Drury Plaza Hotel Broadview Wichita

Audio-Visual Equipment*

Drury Hotels proudly offers a selection of onsite audio-visual equipment available to rent. If your audio-visual request cannot be accommodated using our onsite equipment, our National Group Sales Coordinators can assist in obtaining the additional equipment for your meeting.

ITEM	PRICE
□ High-Speed Wi-Fi for all Attendees	FREE
□ Charging Station	FREE
□ Standard AV Support Package	\$200 / section 1 st day
□ Laser 4k Projector & Screen	\$100 each additional day
□ Choice of 1 Lavalier or Handheld Microphone	
□ Executive AV Support Package	\$250 / section 1 st day
□ Laser 4k Projector & Screen	\$125 each additional day
□ Choice of 2 Microphones - Lavalier or Handheld Combo	
□ Wireless Presenter with Laser Pointer	
□ Premium AV Support Package	\$350 / section 1 st day
□ Laser 4k Projector & Screen	\$175 each additional day
□ Choice of 2 Lavalier or 2 Handheld Microphones	
□ Wireless Presenter with Laser Pointer	
□ Flipchart & Markers	
□ Confidence Monitor	
□ Bluetooth Audio Interface	
□ Laser 4k Projector	\$175
□ Pipe & Drape	\$60 / panel
□ Wireless Lavalier or Handheld Microphone	\$40
□ Polycom Speaker Phone	\$50
□ Flipchart with Easel & Markers	\$15
□ Powerstrips/Extension Cords	\$5 / per
□ Confidence Monitor	\$50 / day
□ Wireless Presenter with Laser Pointer	\$10 / day
□ Bluetooth or Auxiliary Audio Interface	\$20 / day
□ Easels	FREE
□ Podiums	FREE
□ Staging	FREE
□ Dance Floor	FREE

*For the convenience of meeting planners, groups may bring their own audio visual equipment if desired. If the group requires equipment not carried by the hotel, equipment will be ordered from an approved local AV supplier and the customer will be billed the suppliers price through the hotel on the Banquet Event Order. AV equipment and pricing are subject to change. Please contact our Group Sales Department at 1-800-436-1169 for complete details.

All AV equipment includes an extension cord and powerstrip. Pricing and available equipment are subject to change. Listed AV is priced per day and is exclusive of tax.